

longacre®



Longacre Racing Products, Inc.

www.longacreracing.com

(360) 453 2030

To assemble adjustable spanners, slide the inner piece into the outer piece, as shown. Be sure to overlap the outer pieces equally. To set for the wheel base, adjust the spanners to the length of your wheel base minus 17". Fasten together with the 5/16 button head bolts, washers and self locking nuts. Tighten the top set of bolts before tightening the sides. Once assembled the ends of the spanner will clip into place between the two levelers. **Be sure the leveler is COMPLETELY clipped onto the levelers before use.**

*You MUST use 8 self locking nuts, 8 washers and 8 bolts for each spanner.

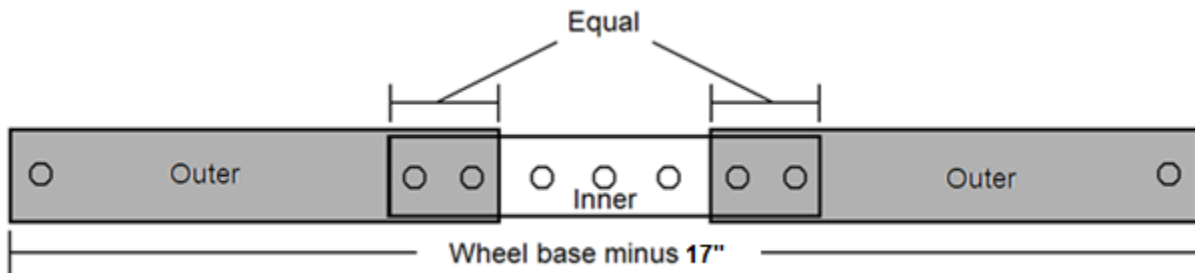

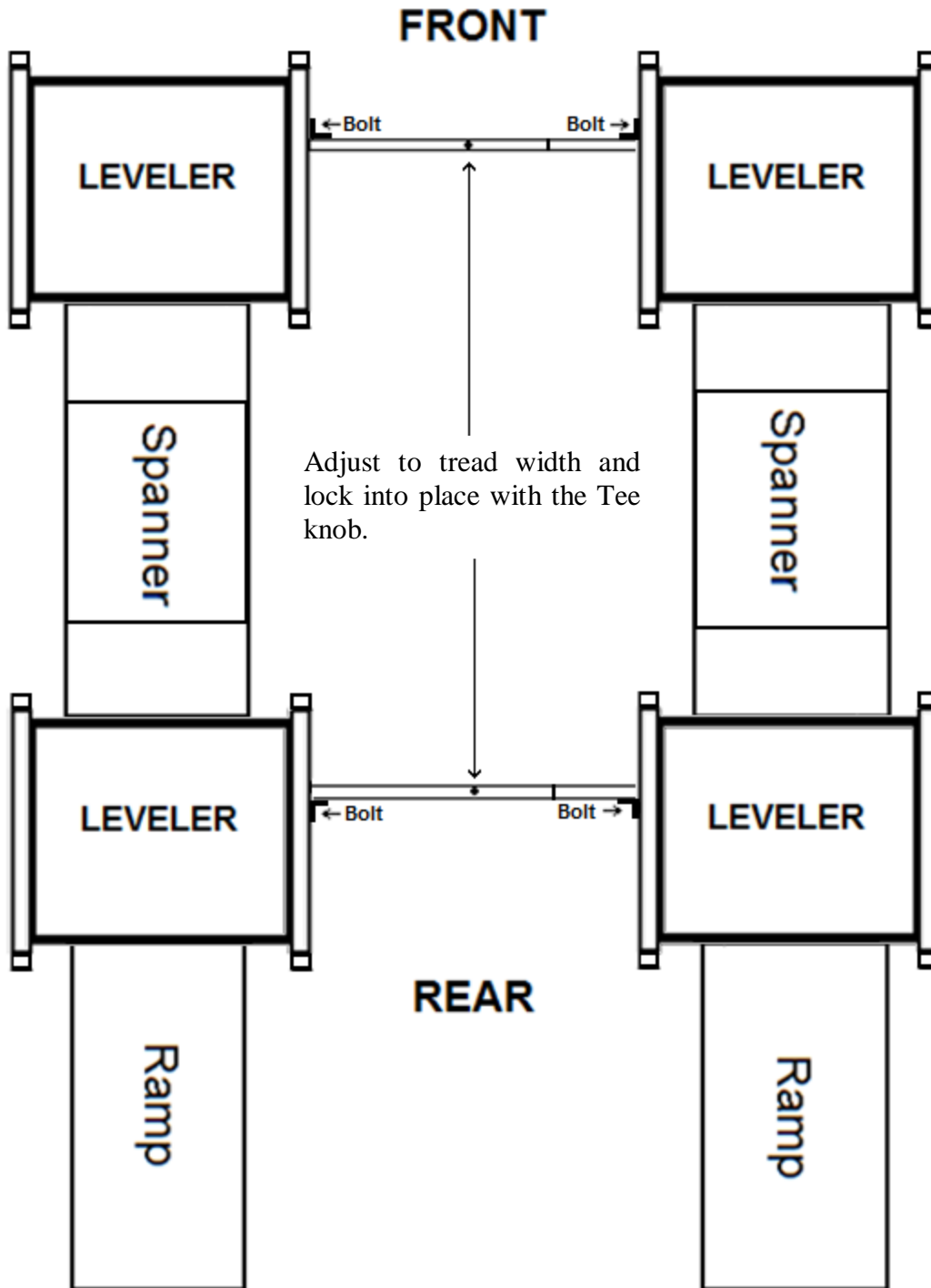

Fasten the width adjustment arm firmly to the sides of both the front and rear levelers.